

Beecroft Building, Uni. of Oxford

Integration & Collaborative Working Winner

Project contract value: £50m
Type of work: New build
Construction product: Science laboratories

Highlights

Unprecedented research facilities in a constrained urban context through close collaboration, extensive engagement with the client team and contractor's supply chain.

- Close temperature control in all 20 laser laboratories (± 0.02 °C) and close room temperature control in all 20 laser laboratories (± 0.2 °C). Vibration criteria VC-F was achieved in Laser Labs through collaborative working.
- The labs will enable Oxford Physics to advance their research areas, such as quantum science and technology, to develop the next generation of computers: trapped ion quantum computers.
- At 16m depth, the basement is Oxford's deepest basement and this is immediately adjacent to existing live research facilities, in one of Oxford's most sensitive sites.

submitted by: **Hoare Lea with University of Oxford, Crown House, Hawkins Brown, CMR and Laing o'Rourke**

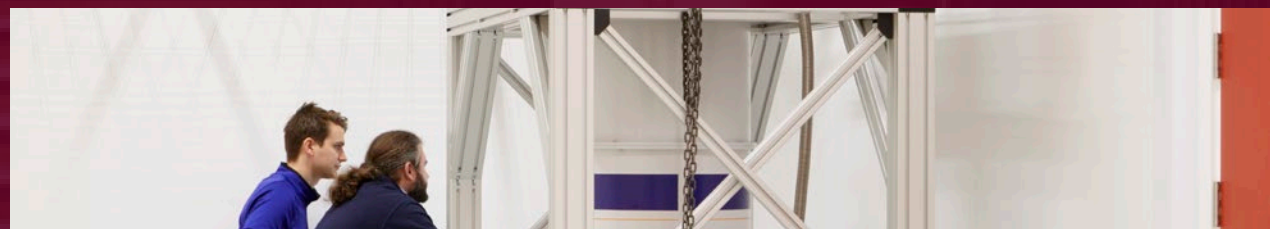
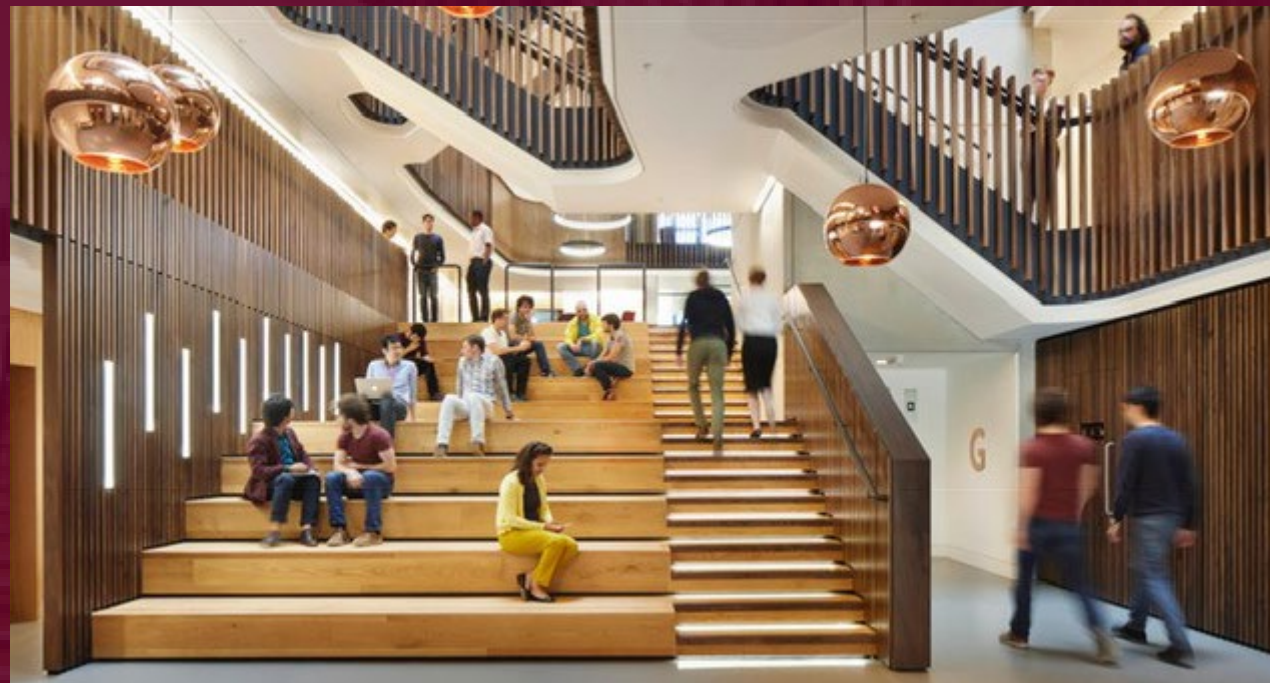

**CONSTRUCTING
EXCELLENCE**
SECBE AWARDS 2019

this award is sponsored by:

